

## Ron 2501 Hook Type Wireless Crane Scale

### TECHNICAL SPECIFICATIONS



**Transmission range:** Up to 150 yards / meters (outdoor, line of sight).

**Safety factor:** 5:1.

**Proof Load:** Each system proof-loaded to 200% of capacity (certified).

**Accuracy:**  $\pm 0.1\%$  of full range.

**Display:** 5 digit,  $\frac{1}{2}$ " (12mm) liquid crystal display with two overload warning levels, max. value (peak hold), low battery (load cell and indicator), tare state (gross or net), measuring unit, charge and programming instructions. Standard display update rate per second: 1 (optional 2/3).

**Sampling Rate:** 200 per second.

**Functions:** Zero. Tare. Battery charge level. Low battery warning one for the load cell and the other for the hand held indicator, displayed on the latter. Max. (peak hold). Two-level overload visual alarms. User calibration.

**Units:** User selectable units (metric tons, short tons (2000 lbs), kgs, lbs, newtons, deca newtons, k. newtons).

**Load Cell Material:** Made of high-strength, aerospace quality, alloy steel, polyurethane coated.

**Indicator Material:** High quality ABS.

**Power:** 3 x AA 1.5 Volt Alkaline disposable batteries in the indicator and 2 x AA batteries in the load cell (optional 4 x AA batteries) for extended battery life, with battery life indication. Batteries rated 3AH will function up to 2000 hours (three months of continuous working). Optional extended battery life of up to 4000 hours is available. Occasional use will extend the life of the batteries up to several years. Adding certain options will shorten the life of the batteries. All settings retained at power off.

**Calibration:** User calibration. Initial factory calibration, fully traceable (certified).

**Temperature Range:**

Load cell:  $-15^{\circ}\text{F}$  to  $+175^{\circ}\text{F}$  ( $-25^{\circ}\text{C}$  to  $+80^{\circ}\text{C}$ ).

Indicator:  $-4^{\circ}\text{F}$  to  $+158^{\circ}\text{F}$  ( $-20^{\circ}\text{C}$  to  $+70^{\circ}\text{C}$ ).

**Environmental:** Weather proof NEMA4, IP65.



Capacities 0.5t - 15t

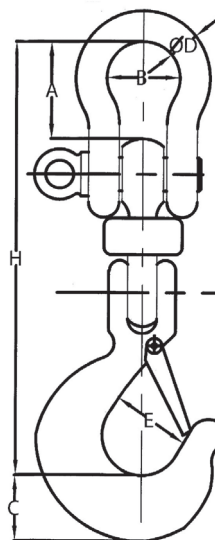

Capacities 20t - 30t

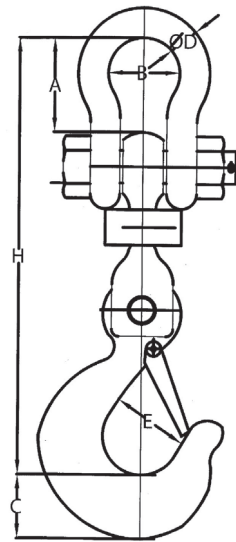

Cat no.	Capacity		Resolution		A		B		C*		Ø D		E*		H	
	ton	kg.	lbs	mm.	inch	mm.	inch	mm.	inch	mm.	inch	mm.	inch	mm.	inch	
H-005	0.5	0.2	0.5	30	1.2	26	1	28	1.1	10	0.4	25	1	235	9.3	
H-01	1	0.5	1	30	1.2	26	1	28	1.1	10	0.4	25	1	235	9.3	
H-0125	1.25	0.5	1	30	1.2	26	1	28	1.1	10	0.4	25	1	235	9.3	
H-016	1.6	1	2	30	1.2	26	1	28	1.1	10	0.4	25	1	235	9.3	
H-025	2.5	1	2	40	1.6	33	1.3	36	1.4	13	0.5	34	1.3	279	11	
H-03	3	1	2	40	1.6	33	1.3	36	1.4	13	0.5	34	1.3	279	11	
H-032	3.2	2	5	40	1.6	33	1.3	36	1.4	13	0.5	34	1.3	279	11	
H-05	5	2	5	50	2	43	1.7	34	1.4	16	0.6	41	1.6	334	13.2	
H-10	10	5	10	82	3.2	68	2.7	58	2.3	25	1	56	2.2	440	17.3	
H-12	12.5	5	10	82	3.2	68	2.7	58	2.3	25	1	56	2.2	440	17.3	
H-15	15	5	10	104	4.1	82	3.2	64	2.5	33	1.3	57	2.2	508	20	
H-20	20	10	20	137	5.3	111	4.3	79	3.1	41	1.6	71	2.8	621	24.5	
H-25	25	10	20	169	6.6	146	5.7	99	3.9	51	2	86	3.4	744	29.3	
H-30	30	10	20	169	6.6	146	5.7	99	3.9	51	2	86	3.4	744	29.3	

> The company reserves the right to make changes without notice.

\* C & E dimensions subject to change. For current dimensions - contact us.

## OPTIONS



- > 1 or 2 user-adjustable set points
  - > Additional 0.5"/12mm LCD display with cable connection to indicator or wireless
  - > Additional 1"/25mm LCD display with cable connection to indicator or wireless
  - > Additional 2"/50mm LCD display with cable connection to indicator or wireless
  - > Additional 5"/125mm LED display with cable connection to indicator or wireless
  - > Additional wireless ABS indicator 0.5"/12mm digits
  - > Additional wireless aluminum indicator 1"/25mm digits
  - > Additional wireless aluminum indicator 2"/50mm digits
  - > Battery life: Extended battery life of up to 4000 hours
  - > Baud rate, user-selectable
  - > Dampened (average) display for unstable loads
  - > Data logger – manual or automatic - up to 600 measurements
  - > Data logger – manual or automatic - up to 3,000 measurements
  - > Data logger – manual or automatic - up to 6,000 measurements
  - > Data logger – manual or automatic - up to 10,000 measurements
  - > Indicator belt clip
  - > IP 67 load cell with special off-shore connectors
  - > IP 68 load cell with underwater capability
  - > Multi-cell: Up to 8 different load cells controlled by a single indicator
  - > Number of measurements per second: 2,3, factory set
  - > Real-time clock
  - > Robust, extruded aluminum, hand-held indicator (1"/25mm or 2"/50mm digits)
  - > Rechargeable batteries with an external charger.
  - > RS-232 - continuous or on demand data output, user-selectable
  - > RS-485 - continuous or on demand data output, user-selectable
  - > Totalizer
  - > USB
- Options for hot industries:**
- > Heat shield for the load cell
  - > Internal load cell thermometer for load cell temperature display on the hand-held indicator